

A wide-angle photograph of a modern lounge or event space. The room features large floor-to-ceiling windows on the left and right, offering a view of a city skyline. The ceiling is high and industrial, with exposed pipes, ductwork, and a grid of dark wooden beams. Several large, spherical pendant lights hang from the ceiling. The furniture includes a mix of armchairs, sofas, and ottomans in neutral tones. A few people are seated in the background, and a large, stylized logo is visible on the wall. The overall atmosphere is bright and contemporary.

Pitch.

Canary Wharf Events



Pitch Wharf

Pitch Wharf was built with hosting spectacular events all year around in mind. Overlooking the Canal and spread across two distinct floors, your guests can enjoy a night to remember where a little competitive fun meets a lot of style and sophistication.

The main floor features a panoramic view of The Wharf, 11 simulator bays, a huge bar and a sprawling lounge with live DJ as requested.

The huge windows are a feature which our guests love and allow attendees to enjoy a rare mix of gaming with sunlight throughout. For very large groups the downstairs bar with outdoor terrace and shuffle area can also be hired to create a blockbuster experience.





Our Games

Experience the modern way to play golf with **virtual games** like Party Putt, Cannon Bowl, and Streets of Neon. Perfect for all skill levels, Trackman games offer challenges from precision tasks to fun showdowns like closest to the pin.

Elevate your event at Pitch with full or half-venue hire, offering activities like **shuffleboard**, **roulette**, **Nintendo Switch** or even casino corner which is always a popular option.

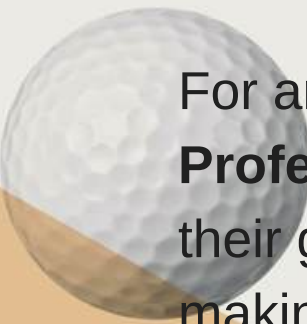

For an added touch, enjoy expert coaching from our **PGA Professionals**—perfect for beginners or those looking to refine their game. Custom arcade games are also available on request, making it ideal for mixed-ability groups.



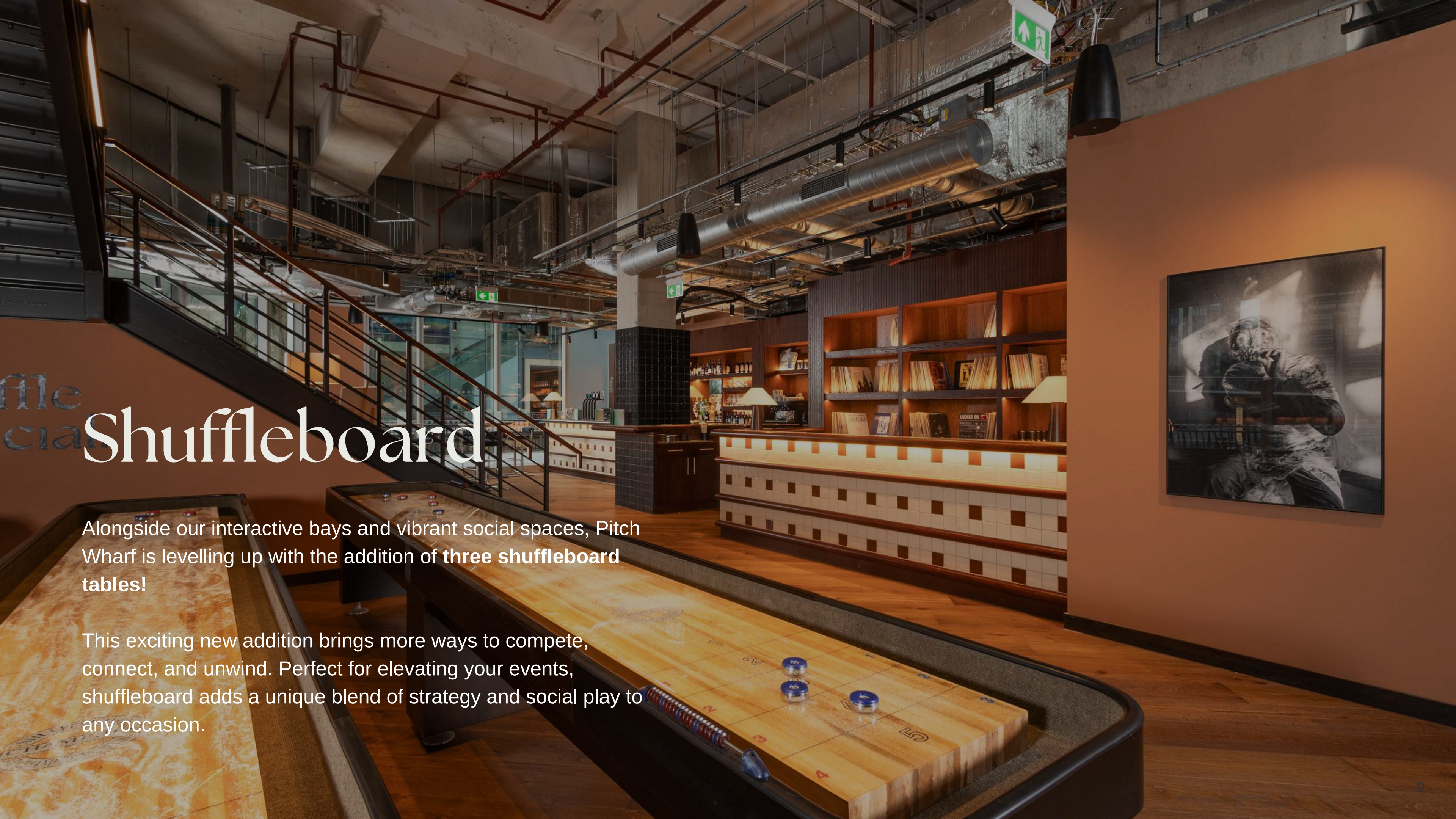

uffle
cian

Shuffleboard

Alongside our interactive bays and vibrant social spaces, Pitch Wharf is levelling up with the addition of **three shuffleboard tables!**

This exciting new addition brings more ways to compete, connect, and unwind. Perfect for elevating your events, shuffleboard adds a unique blend of strategy and social play to any occasion.



Food & Drink

Designed exclusively for Pitch, our JIYŪ menu includes Asian-infused dishes which have been curated by the ex-head chef of the Ivy Steve Tonkin. When mixed with delicious cocktails, Japanese lager and a very modern wine list, your guests will be spoilt for choice.





Our Menu

● = Large dish
● = Small dish
● = Dessert

- Sesame salted edamame* GF
- Togarashi potato wedges* GF
- Chicken karaage, kewpie mayo
- Spicy vegetarian dumplings, red chilli sauce*
- Spicy vegetable bao*
- Crispy duck spring rolls, hoisin sauce
- Chicken & mushroom dumplings, truffle soy
- Char sui pork bao
- Vegatable spring rolls*
- Chicken yakitori skewers
- Peanut butter brownie* GF
- Raspberry, almond and white chocolate slice

*Plant-based options



Canary Events Packages

Perfect for those regular team rewards or the more budget conscious. Our events packages cater for all.
Prices are inclusive of VAT

○ Off-Peak
● Peak



PAR

Two hours of games
Two house drinks
No food
Reservable area

£41pp - £45pp

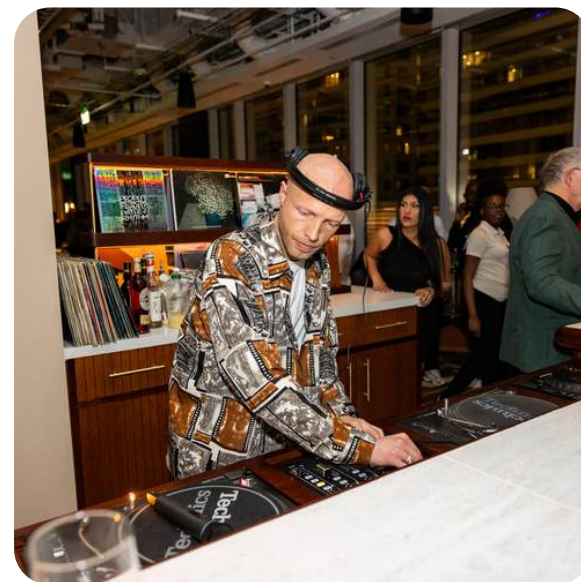

BIRDIE

Two hours of games
Two house drinks
One 'JIYU' dish
Reservable area

£51pp - £55pp



EAGLE

Two hours of games
Two premium drinks
Two 'JIYU' dishes
Reservable area

£63pp - £67pp



ALBATROSS

Three hours of games
Three premium drinks
Three 'JIYU' dishes
Reservable area

£91pp - £95pp



ACE

Four hours of games
Four premium drinks
Three 'JIYU' dishes
Reservable area

£106pp - £110pp

*two prices show booking during Off-Peak/Peak times (Wednesday & Thursday)



Full Venue Hire

Wow your guests with a full venue hire at Pitch Wharf for up to 400 guests, with exclusive access to all gaming bays, shuffleboard tables, the social lounge, and the outdoor terrace.

This is the perfect venue for corporate events, private parties, brand activations, and large-scale celebrations. As one of the largest event spaces in Canary Wharf, Pitch Wharf offers a versatile and dynamic setting that can be tailored to suit a wide range of events.

To secure the space, a **minimum spend of £20K** applies which will vary depending on the day.

Full Venue Hire

Ground Floor -->

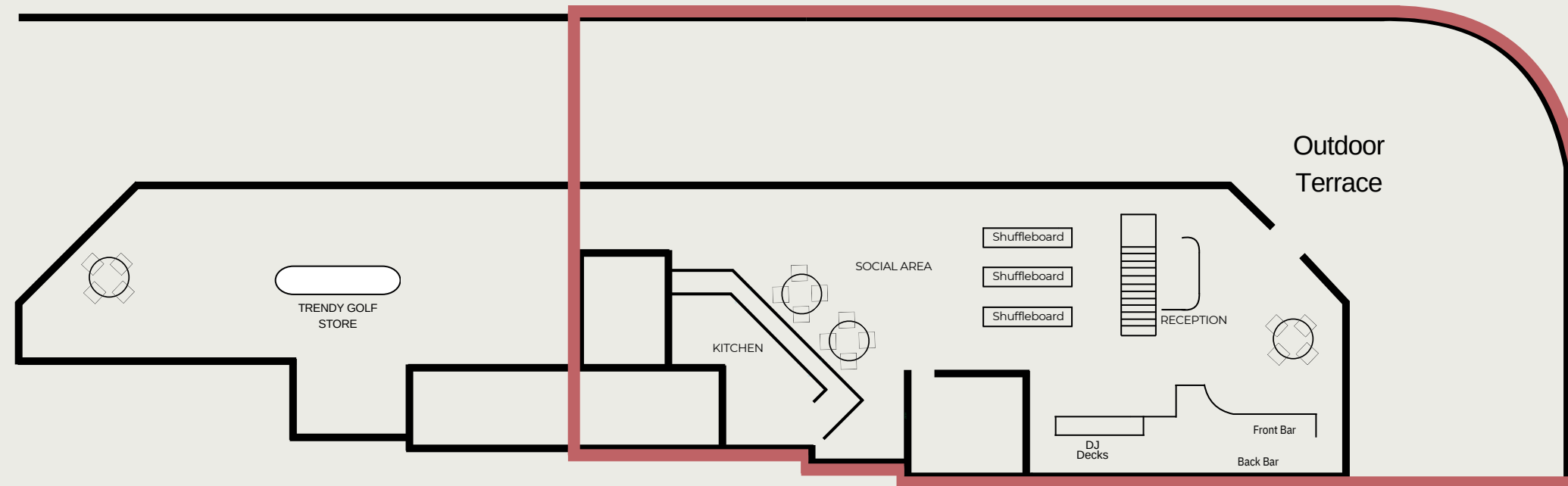

First Floor -->

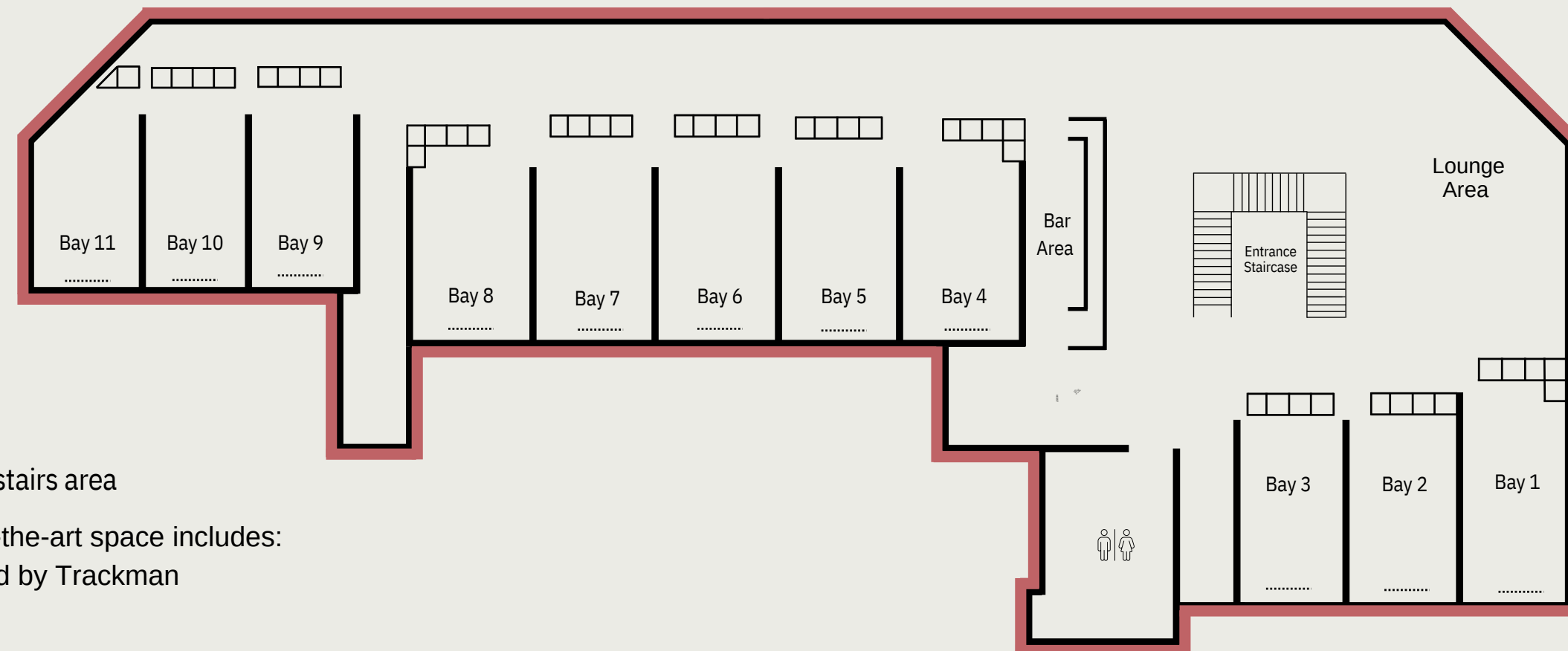

● = Full access to all of downstairs and upstairs area

Covering 14,500 square feet, this state-of-the-art space includes:

- Eleven Ultra-HD gaming bays powered by Trackman
- Two bars and a restaurant
- Riverside terrace with seating
- Panoramic View
- Three Shuffleboards

Half Venue Hire

Half-venue hire at Pitch Wharf offers two flexible options: exclusive access to our upstairs space or a dedicated area downstairs with three to six golf bays and shuffleboard tables. Perfect for team socials, client events, and celebrations, this option provides a vibrant atmosphere while keeping the space private for your group.

Capacity up to 220 people.

To secure the space, a **minimum spend of £9K** applies which will vary depending on the day.

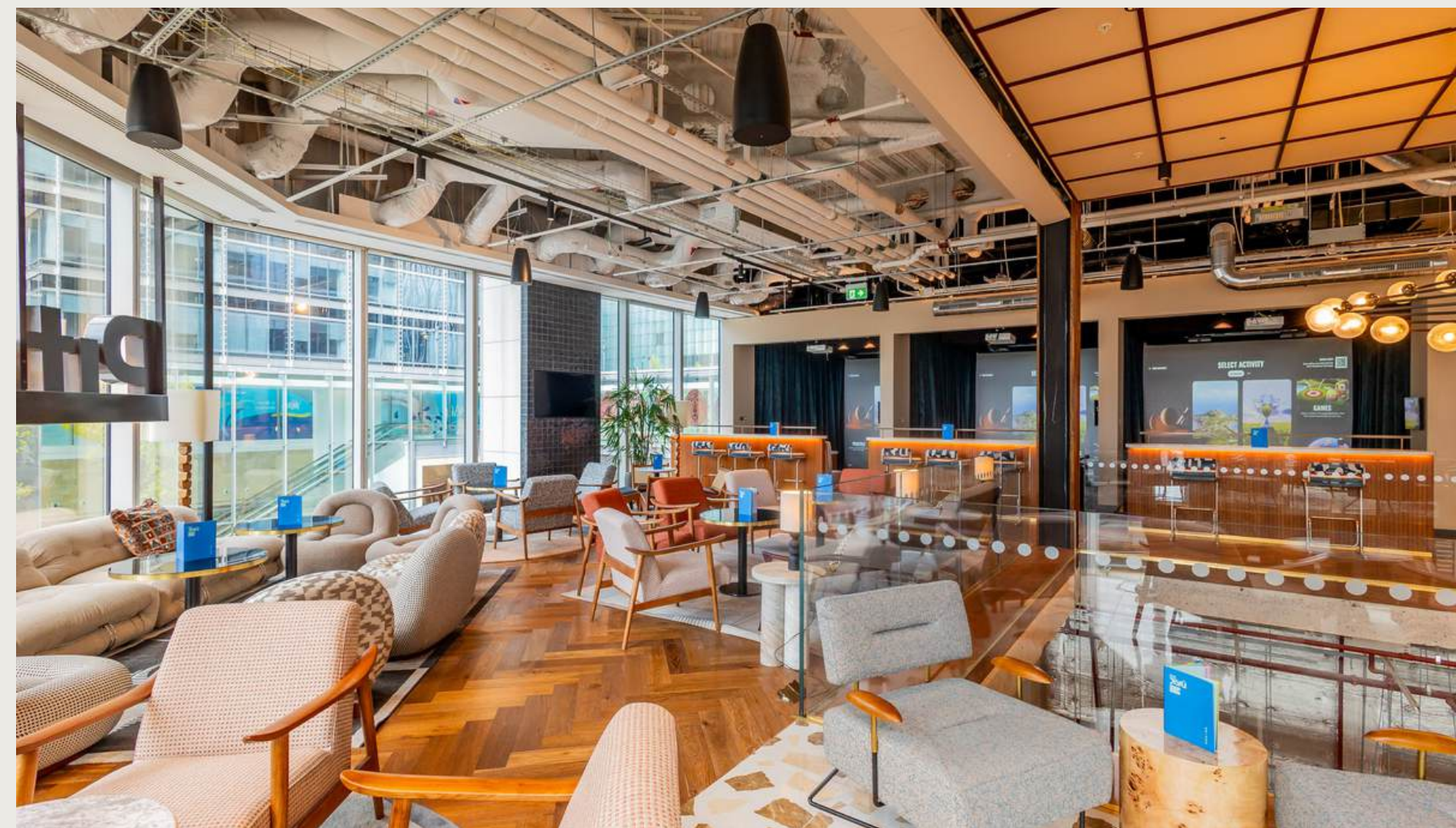

Half Venue Hire

Ground Floor -->

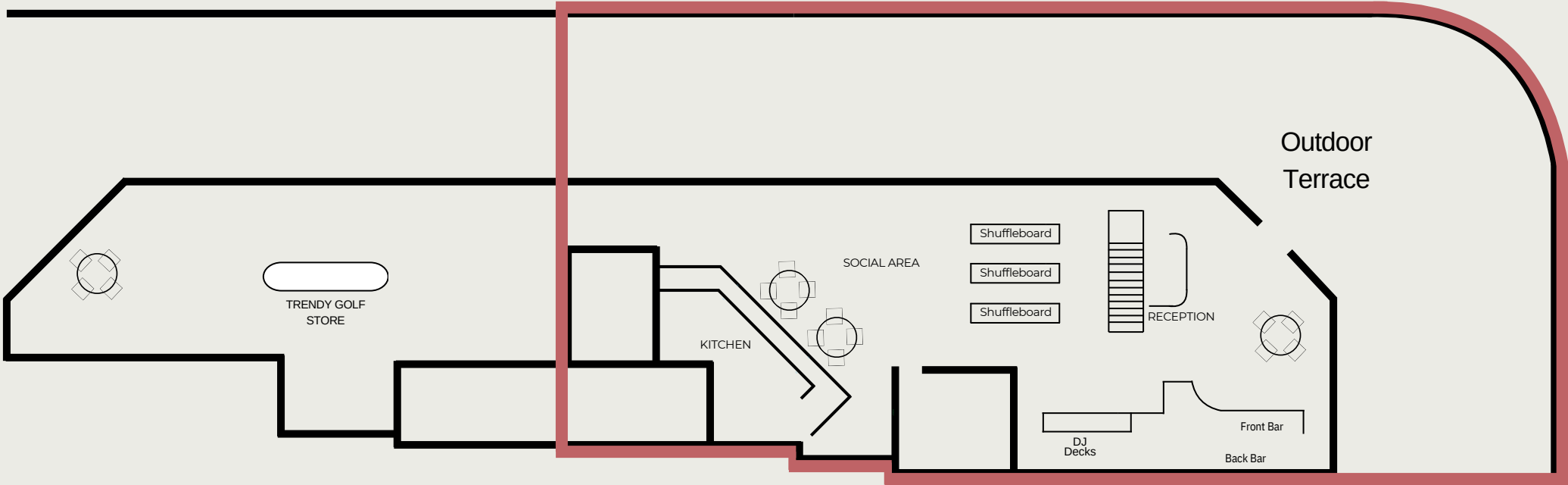

First Floor -->

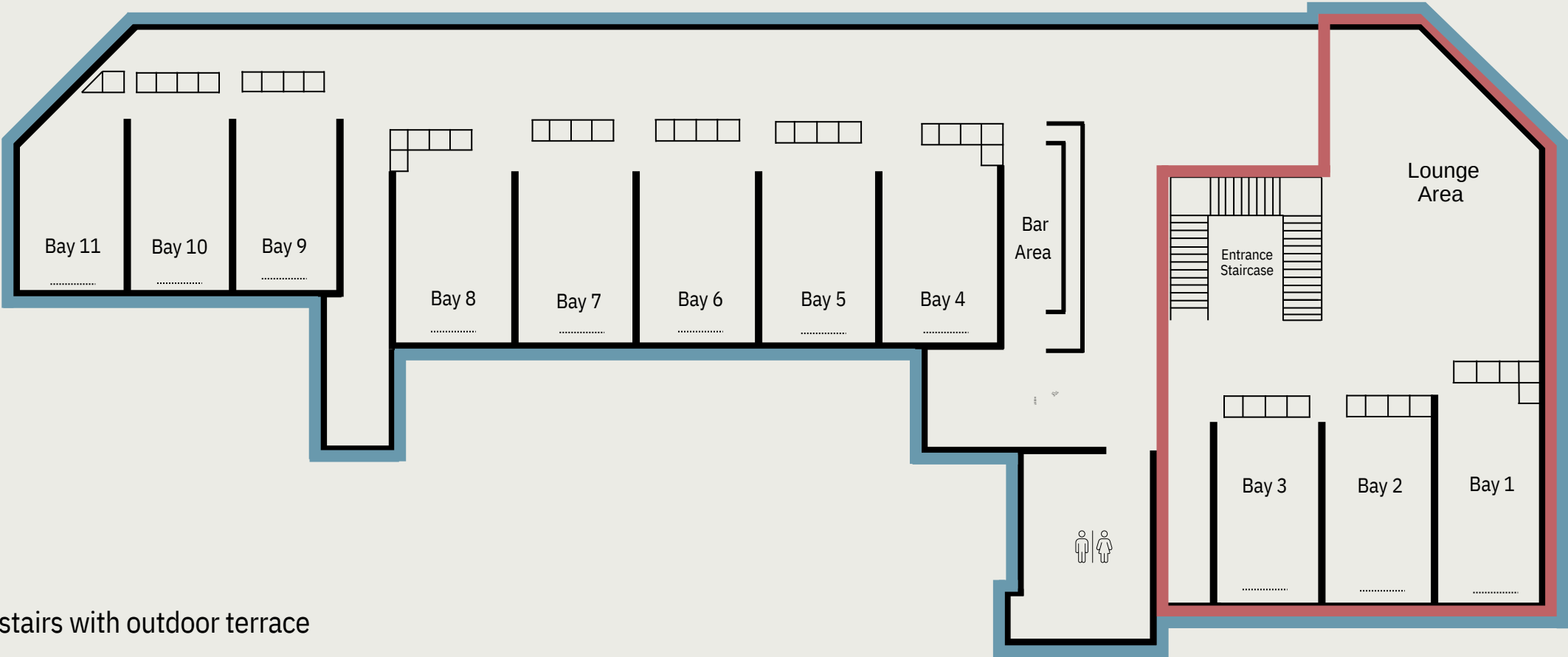

- = Three bays upstairs and area downstairs with outdoor terrace
- = Full access to all of upstairs



Small Area Hire

For a more tailored event experience, our small area hire at Pitch Wharf offers flexible options to suit your needs. Choose from exclusive access to three bays and the downstairs shuffleboard area, five bays and the bar, or a custom setup.

Our private spaces offer exclusive access to top-tier golf technology, lively social areas, and a premium food and drink offering.

Recommended for up to 60 people.

To secure the space, a **minimum spend of £3K** applies which will vary depending on the day.



Small Area Hire

Ground Floor -->

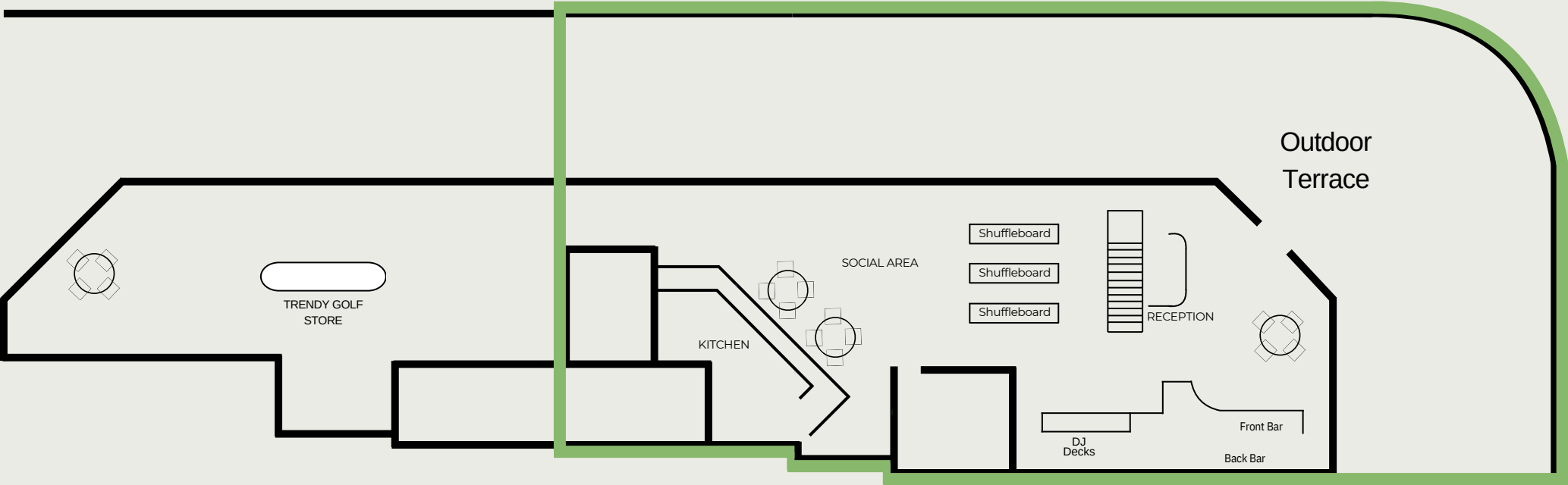

First Floor -->

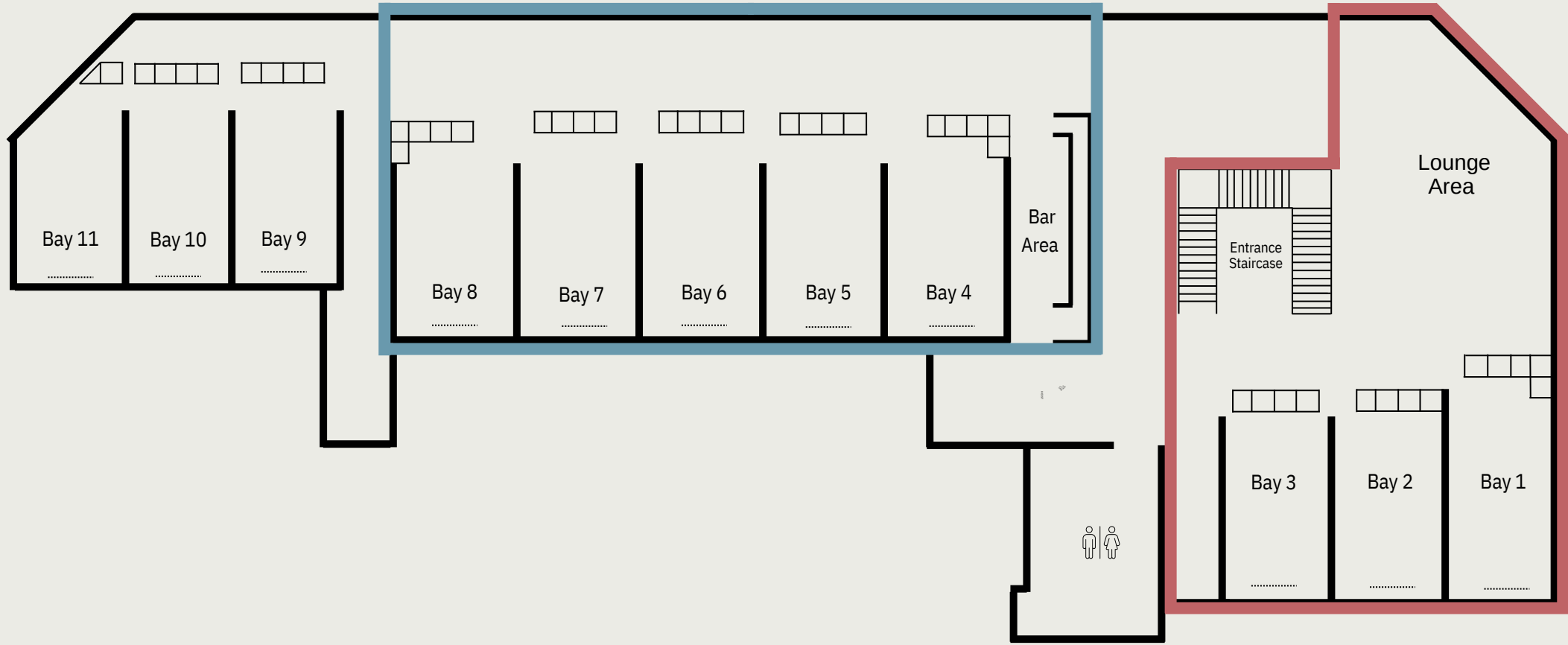

- = Upstairs 5 bays and bar
- = Upstairs 3 bays
- = Downstairs social area

Shuffleboard Events

Our shuffleboard area and downstairs bar provides the perfect setting for a lively and social event. With plenty of space to play, enjoy great drinks, and soak up the atmosphere, it's the ultimate spot for some friendly competition.

For those of you looking for either an event with a higher capacity or to mix activities to suit all tastes, our “Shuffle social” area is a great option to entertain your guests.

Up to 200 if utilising the outdoor terrace.

To secure the space, a **minimum spend of £2K** applies which will vary depending on the day.

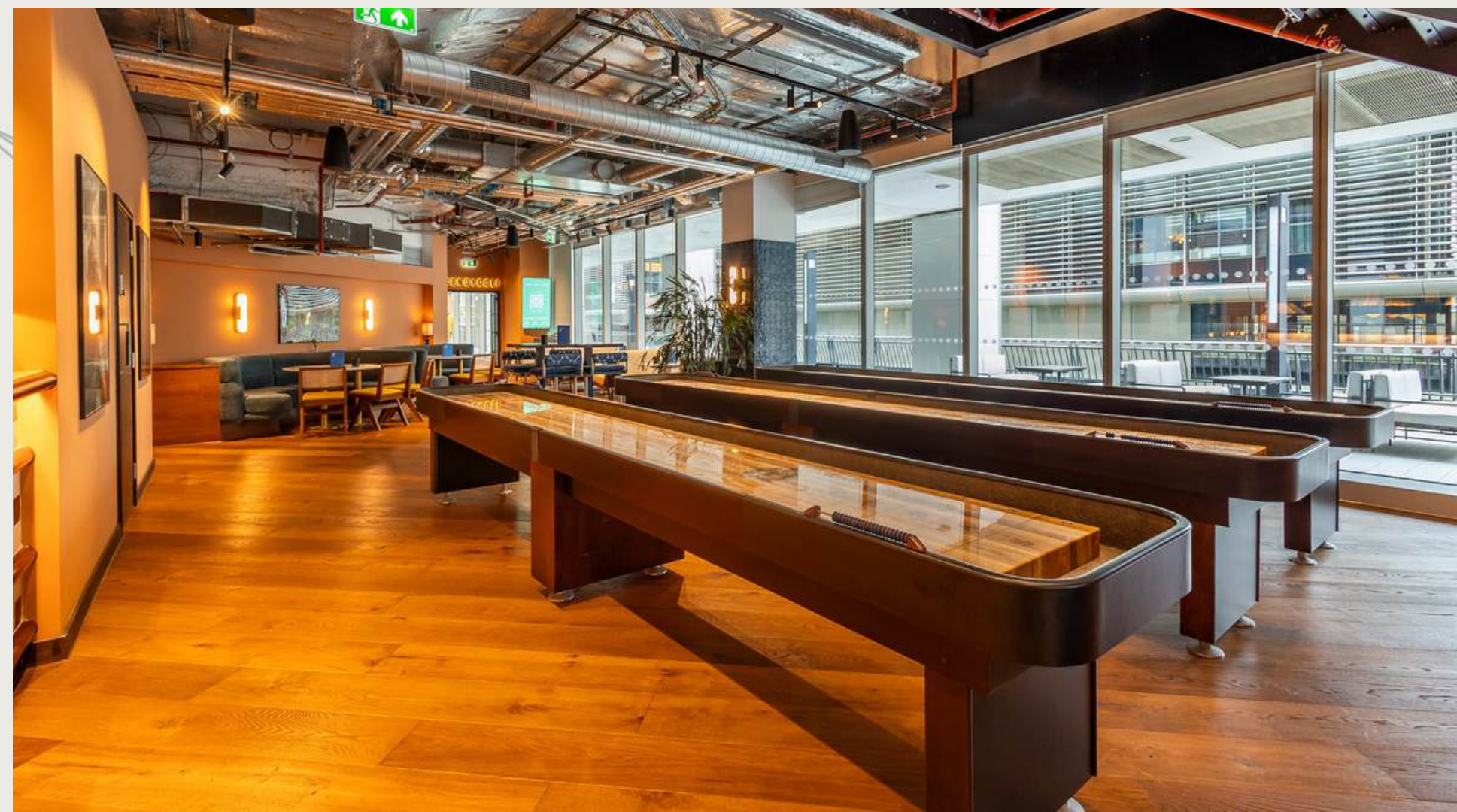

Shuffleboard Area Hire

Ground Floor -->

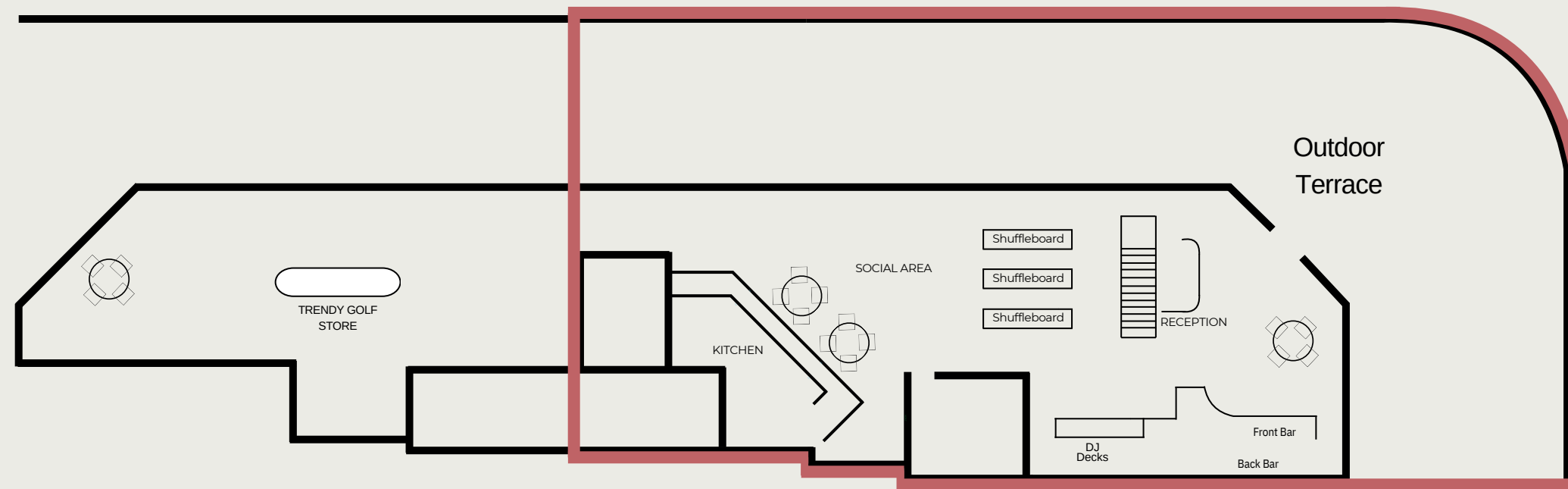

● = Downstairs shuffleboard area and outdoor terrace



Outdoor Hire



Our outdoor terrace and downstairs bar offers a fantastic space for enjoying drinks in a relaxed yet vibrant atmosphere, perfect for after-work gatherings or social occasions during the summer months.

With a capacity for up to 150 guests, it provides a stylish setting for hosting colleagues or clients in a comfortable and inviting environment.

There are options to hire the entire outdoor space as a stand alone option or as part of the lower ground floor with dining space, shuffleboard and a live DJ all options to compliment your summer event.

To secure the space, a **minimum spend of £1K** applies which will vary depending on the day and whether the lower ground bar is included.



The image shows a modern building's glass facade at night. The word "Pitch" is displayed in large, white, illuminated letters across the middle of the windows. To the left, a modern interior is visible, featuring a chandelier with multiple small, round, glowing light bulbs. Green exit signs are visible on the interior walls. The overall lighting is warm and modern.

Pitch

Contact Us

For any enquiries, please contact our events team:
events@pitchldn.co.uk

Canary

30 Churchill Place
London
E14 5EU